

## Tender Text



Nr. Produs: La cerere

**ALPHA3 25-60 180**

High-efficiency circulator pump with permanent-magnet motor (ECM technology) and integrated electronic performance adaptation due to continuously variable speed control for circulation of clean heating water according to VDI 2035.

Features and benefits:

- New Read out of pump performance. Enable the use of ALPHAreader for heat emission balancing.
- New Adv. Dry run protection. Protect the pump in case of no water in the pump.
- New Improved start. Secure start under tough conditions
- New Manual Summer mode. Save energy during summertime and ensure safe start in the heating season
- AUTOADAPT function will automatically find the best setpoint- save energy consumption and set-up time.
- Insulating shells are supplied with pumps to minimize heat loss in heating and cooling systems.
- Display showing actual power consumption in Watt or actual flow in m<sup>3</sup>/h to control design paramters.
- Best energy efficiency index (EEI) in the market provide highest energy savings during a year.
- Stainless-steel pump housings are available if the application is sensitive or SS is a demand.
- Energieeinsparverordnung – EnEV §14(3). Complies with the German regulation for energy saving in buildings and building systems
- Automatic Night Setback that further reduces the energy consumption.
- Simple selection among three constant-pressure curves, three proportional-pressure curves or three fixed speeds with only one button . Quick and simple setup.
- ALPHA plug. Easy, quick and safe electrical connection.
- ALPHA2 is suitable for cold-water systems. Higher application flexibility .
- Electro-coated pump housing. No corrosion issues.
- No external motor protection is required. Reduced installation time and costs.

**Liquid:**

Lichide pompatate: Ap  
Gama temperaturii lichidului: 2 .. 110 °C  
Temp. lichid: 60 °C  
Densitate: 983.2 kg/m<sup>3</sup>

**Technical:**

Clasa TF: 110  
Aprob ri pe etichet : VDE,GS,CE

**Materials:**

Corpul pompei (stator): Font  
EN-GJL-150  
ASTM A48-150B  
Rotor: PES 30%GF

**Instala ie:**

Gama temperaturii ambientale: 0 .. 40 °C  
Presiune de func ionare maxim : 10 bar  
Racordarea pompei la instala ie: G 1 1/2  
Presiune maxim de func ionare: PN 10  
Distan a dintre porturi: 180 mm

**Electrical data:**

Power input - P1: 3 .. 34 W  
Frecven a re elei electrice: 50 Hz  
Tensiune nominal : 1 x 230 V  
Curent consumat maxim: 0.04 .. 0.32 A  
Grad de protec ie (IEC 34-5): X4D  
Clas de izolare (IEC 85): F

**Others:**

Energy (EEI): 0.17  
Greutate net : 2.01 kg  
Greutate brut : 2.13 kg  
Volum de transport: 0.004 m<sup>3</sup>

Pozitie	Cant.	Descriere
	1	<p><b>ALPHA3 25-60 180</b></p>  <p>Nr. Produs: La cerere</p> <p>High-efficiency circulator pump with permanent-magnet motor (ECM technology) and integrated electronic performance adaptation due to continuously variable speed control for circulation of clean heating water according to VDI 2035.</p> <p>Features and benefits:</p> <ul style="list-style-type: none"> <li>• New Read out of pump performance. Enable the use of ALPHAreader for heat emission balancing.</li> <li>• New Adv. Dry run protection. Protect the pump in case of no water in the pump.</li> <li>• New Improved start. Secure start under tough conditions</li> <li>• New Manual Summer mode. Save energy during summertime and ensure safe start in the heating season</li> <li>• AUTOADAPT function will automatically find the best setpoint- save energy consumption and set-up time.</li> <li>• Insulating shells are supplied with pumps to minimize heat loss in heating and cooling systems.</li> <li>• Display showing actual power consumption in Watt or actual flow in m<sup>3</sup>/h to control design paramters.</li> <li>• Best energy efficiency index (EEL) in the market provide highest energy savings during a year.</li> <li>• Stainless-steel pump housings are available if the application is sensitive or SS is a demand.</li> <li>• Energieeinsparverordnung – EnEV §14(3). Complies with the German regulation for energy saving in buildings and building systems</li> <li>• Automatic Night Setback that further reduces the energy consumption.</li> <li>• Simple selection among three constant-pressure curves, three proportional-pressure curves or three fixed speeds with only one button . Quick and simple setup.</li> <li>• ALPHA plug. Easy, quick and safe electrical connection.</li> <li>• ALPHA2 is suitable for cold-water systems. Higher application flexibility .</li> <li>• Electro-coated pump housing. No corrosion issues.</li> <li>• No external motor protection is required. Reduced installation time and costs.</li> </ul> <p><b>Liquid:</b>            Lichide pompatate: Ap            Gama temperaturii lichidului: 2 .. 110 °C            Temp. lichid: 60 °C            Densitate: 983.2 kg/m<sup>3</sup></p> <p><b>Technical:</b>            Clasa TF: 110            Aprob ri pe etichet : VDE,GS,CE</p> <p><b>Materials:</b>            Corpul pompei (stator): Font            EN-GJL-150            ASTM A48-150B            Rotor: PES 30%GF</p> <p><b>Instalatie:</b>            Gama temperaturii ambientale: 0 .. 40 °C            Presiune de func ionare maxim : 10 bar            Racordarea pompei la instala ie: G 1 1/2            Presiune maxim de func ionare: PN 10</p>

Pozi ie	Cant.	Descriere
		Distan a dintre porturi: 180 mm
		<b>Electrical data:</b>
		Power input - P1: 3 .. 34 W
		Frecven a re elei electrice: 50 Hz
		Tensiune nominal : 1 x 230 V
		Curent consumat maxim: 0.04 .. 0.32 A
		Grad de protec ie (IEC 34-5): X4D
		Clas de izolare (IEC 85): F
		<b>Others:</b>
		Energy (EEI): 0.17
		Greutate net : 2.01 kg
		Greutate brut : 2.13 kg
		Volum de transport: 0.004 m <sup>3</sup>

## La cerere ALPHA3 25-60 180 50 Hz

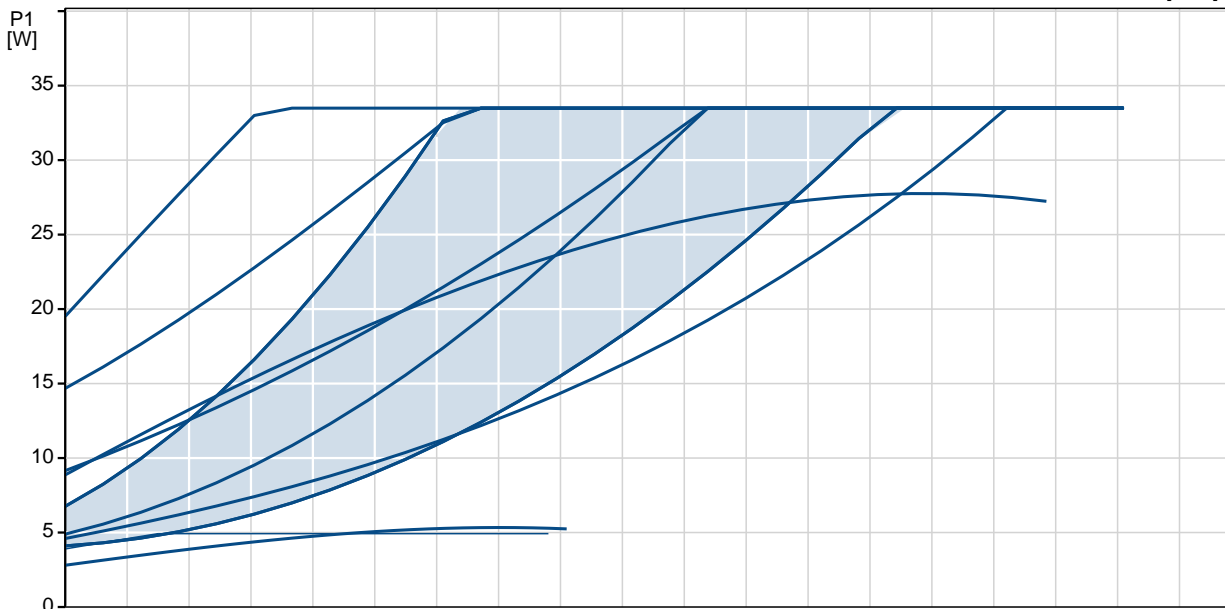
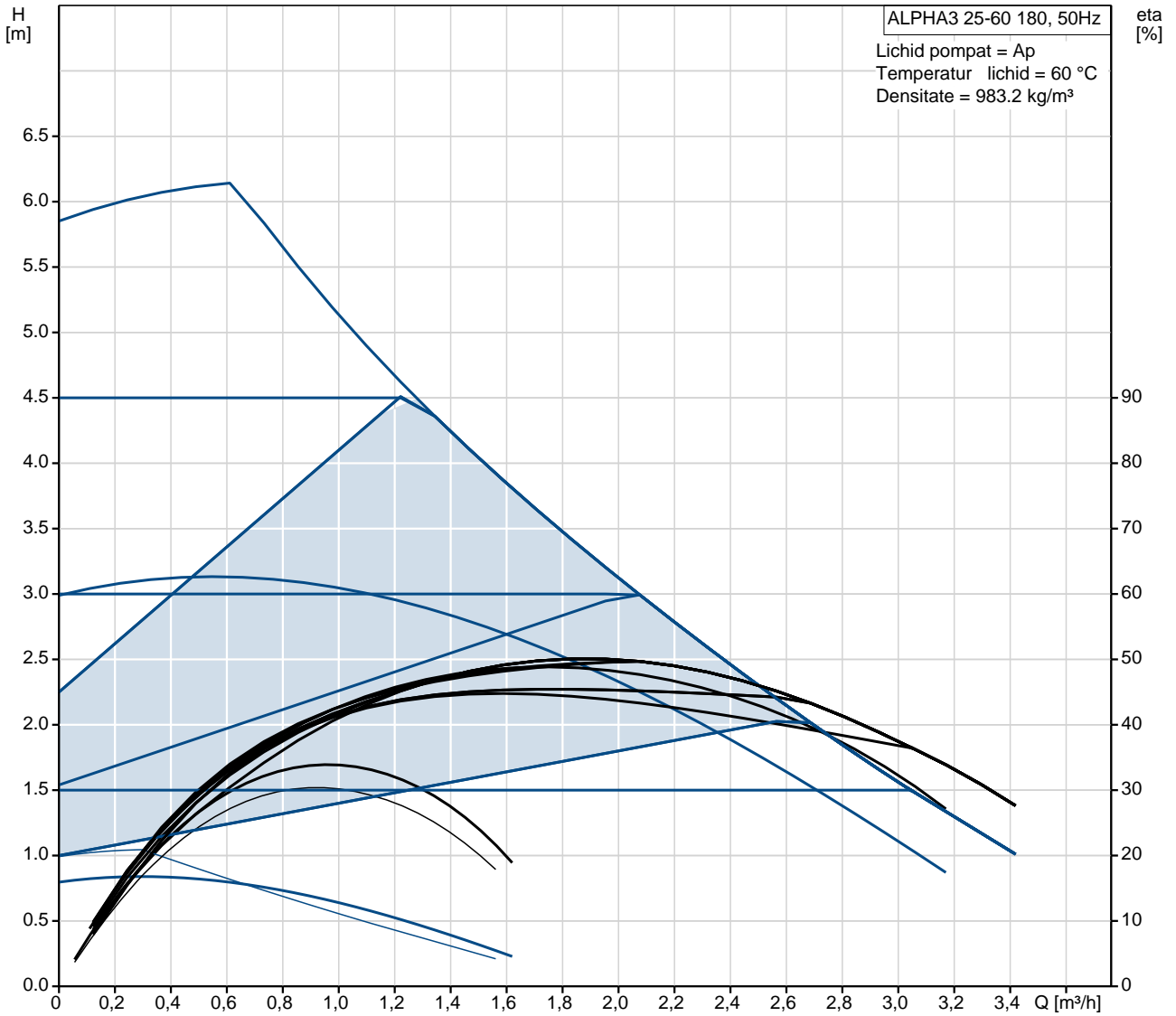

Descriere	Valori i tipuri
<b>Informa ii generale:</b>	
Nume produs::	ALPHA3 25-60 180
Nr. produs::	La cerere
Numărul EAN::	La cerere
Pre :	La cerere
<b>Technical:</b>	
În l ime de pompare max.:	60 dm
Clasa TF:	110
Aprob ri pe etichet :	VDE,GS,CE
Model:	A
<b>Materials:</b>	
Corpul pompei (stator):	Font EN-GJL-150
	ASTM A48-150B
Rotor:	PES 30%GF
<b>Instala ie:</b>	
Gama temperaturii ambientale:	0 .. 40 °C
Presiune de func ionare maxim :	10 bar
Racordarea pompei la instala ie:	G 1 1/2
Presiune maxim de func ionare:	PN 10
Distan a dintre porturi:	180 mm
<b>Liquid:</b>	
Lichide pompate:	Ap
Gama temperaturii lichidului:	2 .. 110 °C
Temp. lichid:	60 °C
Densitate:	983.2 kg/m <sup>3</sup>
<b>Electrical data:</b>	
Power input - P1:	3 .. 34 W
Frecven a re elei electrice:	50 Hz
Tensiune nominal :	1 x 230 V
Curent consumat maxim:	0.04 .. 0.32 A
Grad de protec ie (IEC 34-5):	X4D
Clas de izolare (IEC 85):	F
Tip protec ie motor încorporat :	F R
Protec ie termic :	ELEC
<b>Controls:</b>	
Automat noaptea:	func ionare redus automat pe timp te noapte inclus
Pozi ia cutiei de conexiuni:	6H
<b>Others:</b>	
Energy (EEI):	0.17
Greutate net :	2.01 kg
Greutate brut :	2.13 kg
Volum de transport:	0.004 m <sup>3</sup>

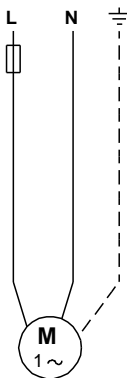
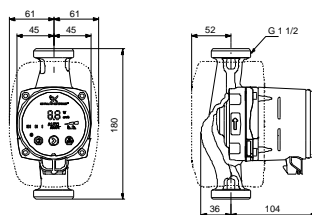
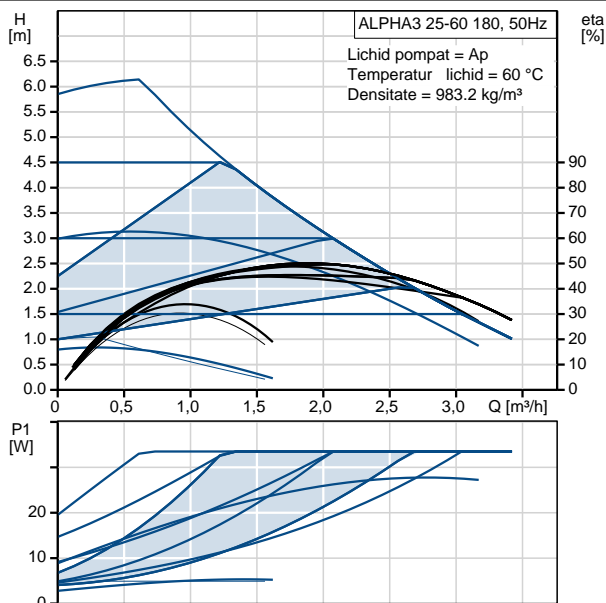

## La cerere ALPHA3 25-60 180 50 Hz

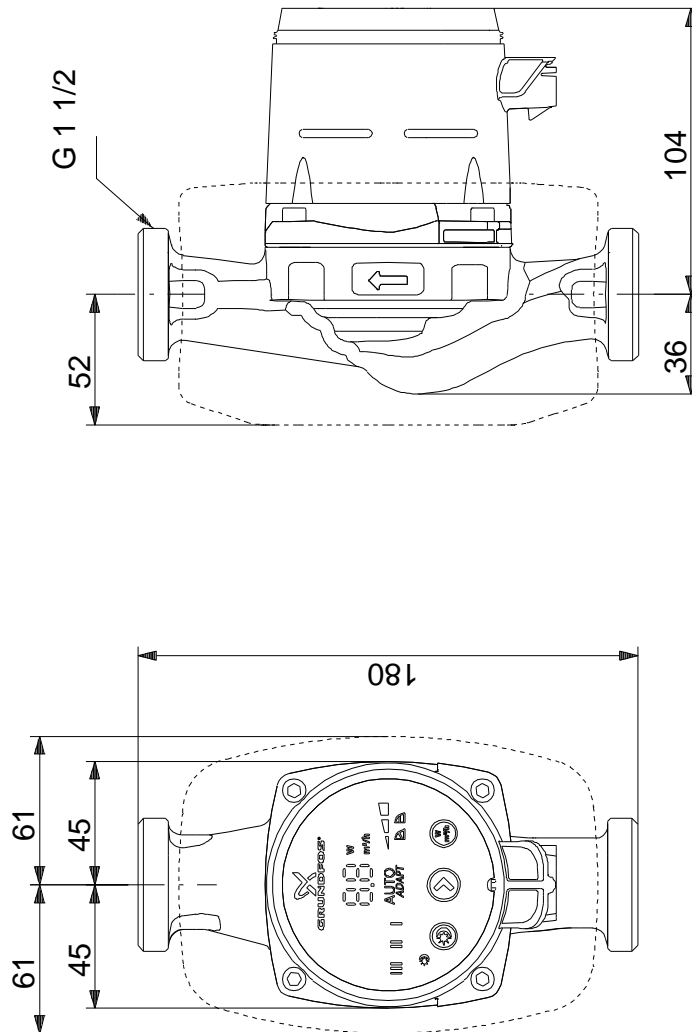

Note! All units are in [mm] unless others are stated.  
Disclaimer: This simplified dimensional drawing does not show all details.

**La cerere ALPHA3 25-60 180 50 Hz**

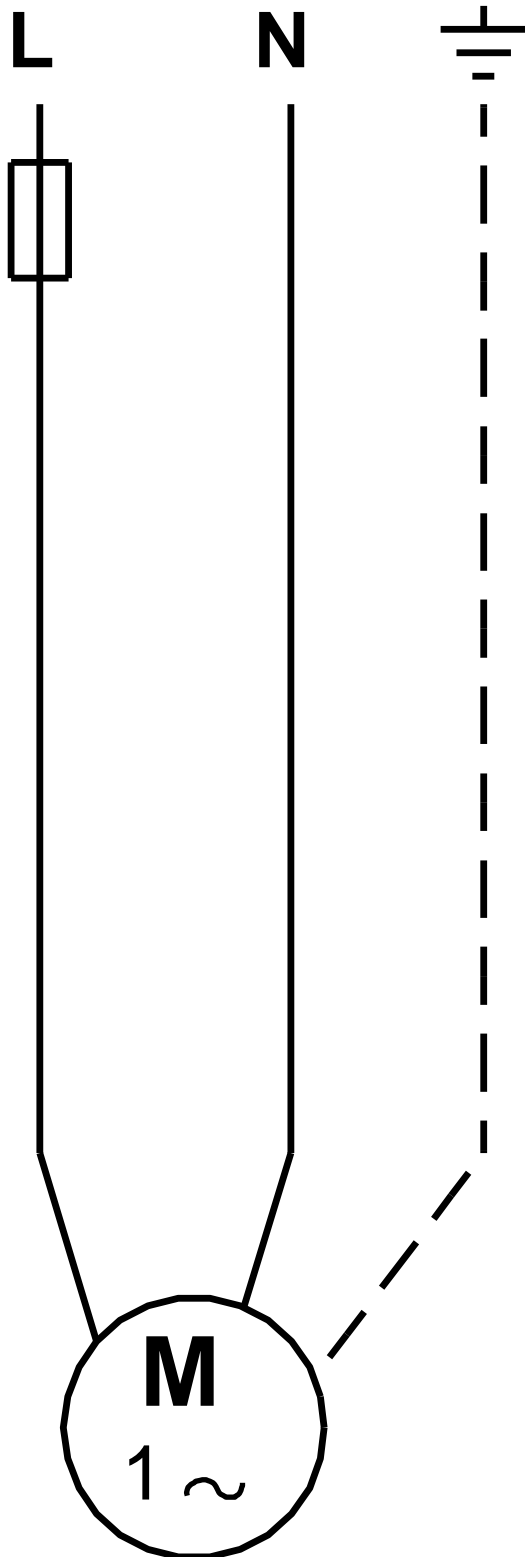

Not ! Toate unit ile sunt în [mm] dac nu altele sunt condi iile.